



# Australasian Course in Advanced Neuroscience

## 2026 Course Program

● Neurons to Networks

● Networks to Systems

● Systems to Behaviour



**UNSW**  
SYDNEY

INTERNATIONAL BRAIN

**IBRO**  
RESEARCH ORGANIZATION



**Neurological  
Foundation**  
A pathway to hope



## Table of Contents

<b>Course Site Map &amp; Commute</b> .....	<b>2</b>
<b>Floor Plan</b> .....	<b>3</b>
<b>Program</b> .....	<b>5</b>
Welcome   Sunday 10 May.....	5
<b>Theme 1   Neurons to Networks</b> .....	<b>6</b>
Monday 11 May – Fundamentals of Electrophysiology.....	6
Tuesday 12 May – Building Blocks of Neurons .....	7
Wednesday 13 May – Neuronal Communication .....	8
Thursday 14 May – Synaptic Plasticity .....	9
Friday 15 May – Neuronal Operation .....	10
Saturday 16 May – Neuronal Function .....	11
<b>Theme 2   Networks to Systems</b> .....	<b>12</b>
Monday 18 May – Measuring Neural Function with Light .....	12
Tuesday 19 May – Controlling Neural Function with Light .....	13
Wednesday 20 May – A Window to Neural Function .....	14
Thursday 21 May – Functional Imaging in Whole Systems .....	15
Friday 22 May – Functional Imaging in Whole Systems .....	16
Saturday 23 May – Wrap Up! .....	17
<b>Theme 3   Systems to Behaviour</b> .....	<b>18</b>
Monday 25 May – Learning & Behaviour.....	18
Tuesday 26 May – Setting up Brain Systems.....	19
Wednesday 27 May – Learning & Neuromodulation (I) .....	20
Thursday 28 May – Learning & Neuromodulation (II) .....	21
Friday 29 May – Systems Failure .....	22
Saturday 30 May – Wrap Up! .....	23
<b>Course Faculty</b> .....	<b>24</b>
Board of Directors   Coordinators   Lecturers .....	24
Instructors.....	25
<b>Students</b> .....	<b>26</b>
<b>Student biosketches</b> .....	<b>27</b>
<b>Institutional Support and Sponsors</b> .....	<b>33</b>



COURSE **SITE MAP & COMMUTE**



ACAN (Wallace Wurth building)

Sydney Lodges (Perouse Randwick)



Entry vial UNSW **Gate 10**

Entry via **Perouse Road**

Coogee beach (follow Coogee beach Rd)



FLOOR PLAN

Wallace Wurth building (WW)

**WW Ground Level** (Lecture spaces)

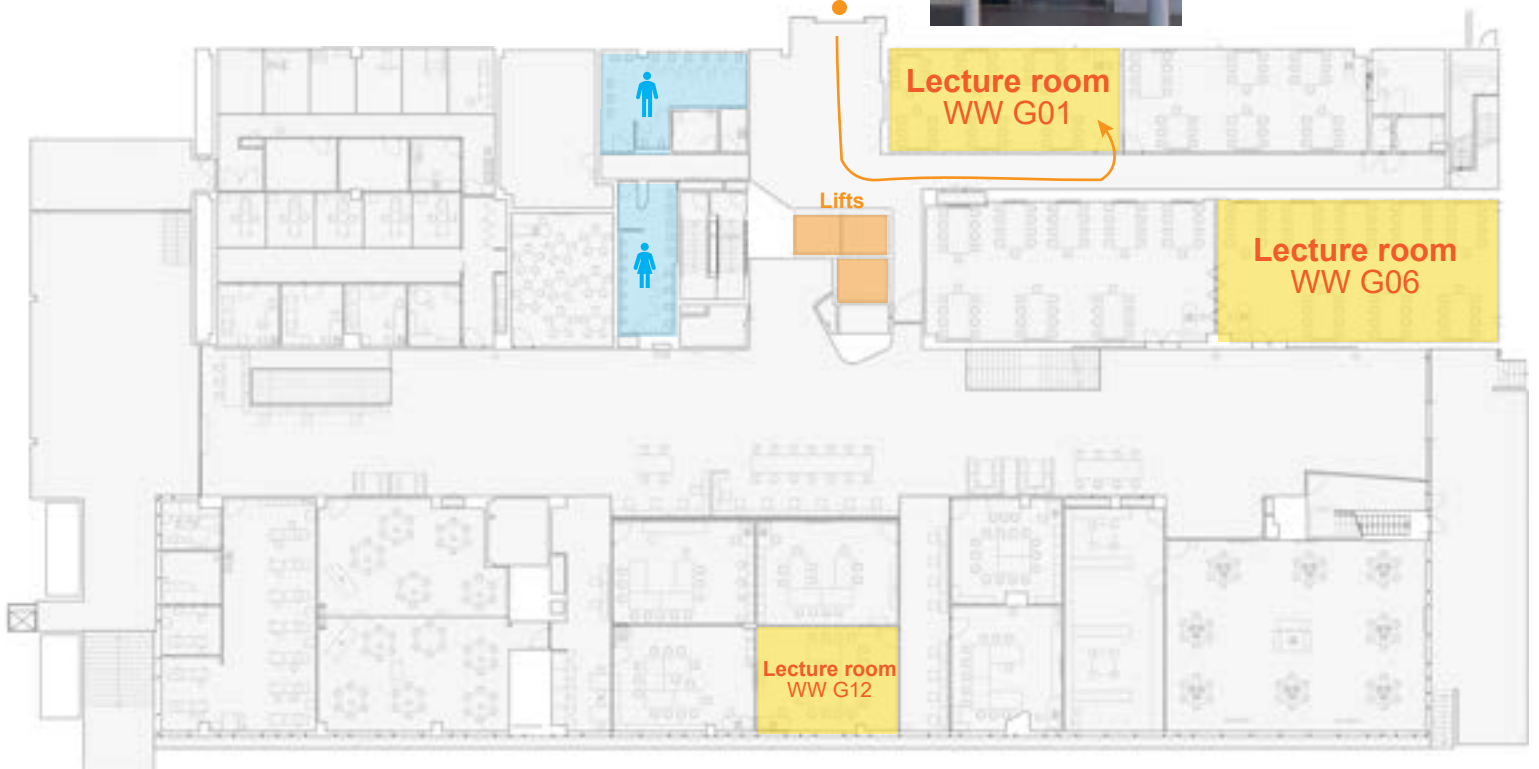
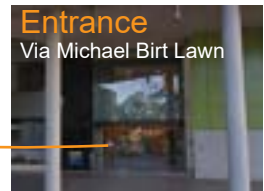

**WW Level 3**

(Ephys & Imaging spaces)

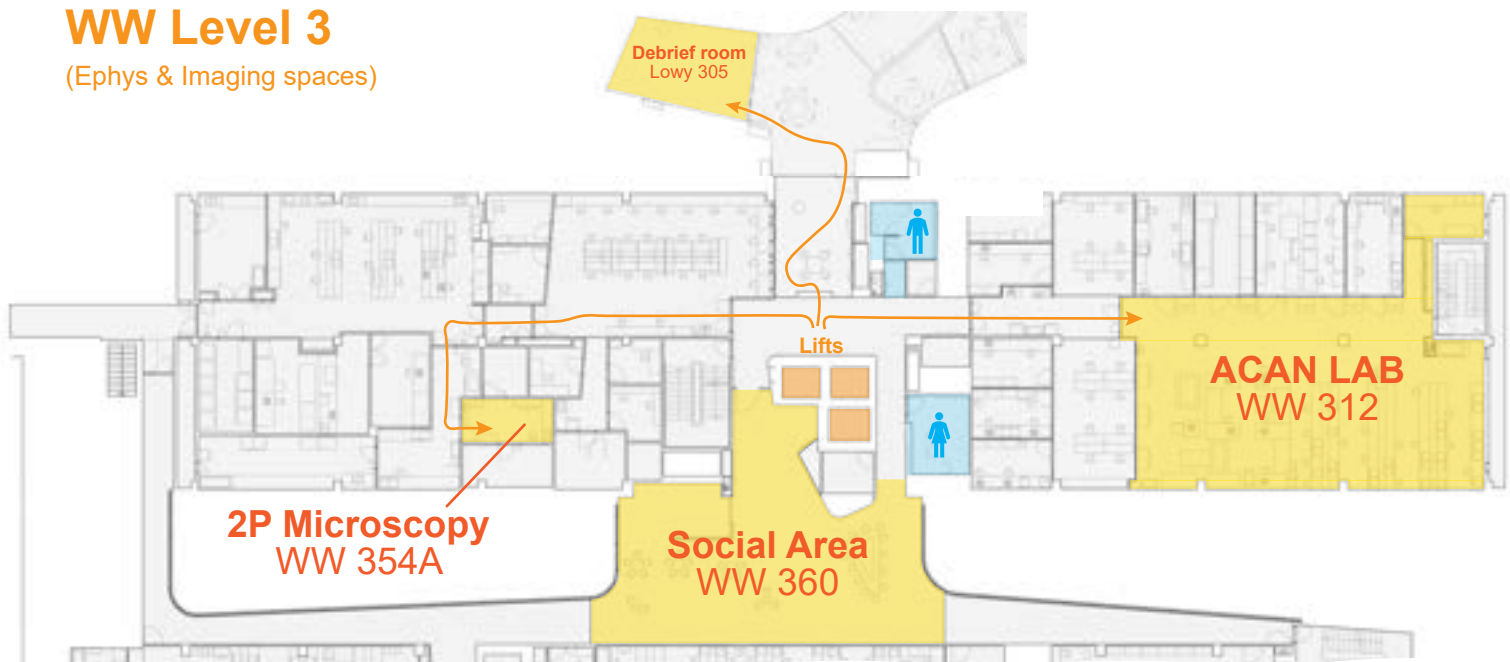

FLOOR PLAN

Wallace Wurth building (WW)

**WW Lower Ground** (Evening Lectures, Behaviour & Surgery spaces)

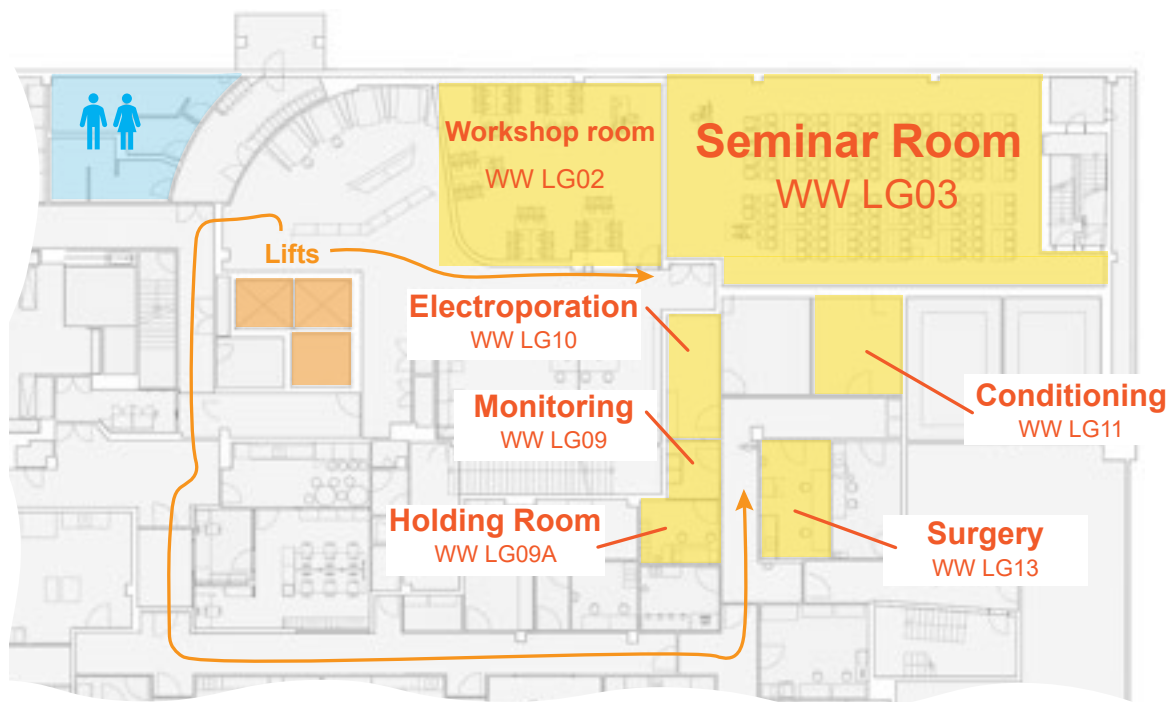

## Welcome | Sunday 10 MAY

Important: This program is a preliminary draft. Some sessions, venues, and participant details are still being confirmed. Provisional or TBD/TBA items are highlighted in yellow and will be updated as confirmations are received.

### **EVENING SESSION**

Functions Patio (**AGSM G27**)

17:30 – 18:15

Welcome drinks | Course Introduction

<b>Alan Finkel</b>	<i>ACAN Founder (tbc)</i>
<b>Jason Mattingley</b>	<i>ANS President (tbc)</i>
<b>John Bekkers</b>	<i>Former ACAN Director</i>
<b>Stephen Williams</b>	<i>Former ACAN Director</i>
<b>Chris Reid</b>	<i>Former ACAN Director</i>
<b>Jay Bertran-Gonzalez</b>	<i>Course Director</i>
<b>Lee Fletcher</b>	<i>Co-director</i>
<b>Christina Mo</b>	<i>Co-director</i>
<b>John Power</b>	<i>Co-director</i>
<b>Robyn Brown</b>	<i>Co-director</i>
<b>ACAN Faculty and Students</b>	

18:30 – 20:30

Functions Patio (**AGSM G27**)

**WELCOME DINNER**

Students and Faculty



# THEME 1 | NEURONS to NETWORKS

Monday 11 MAY

## FUNDAMENTALS OF ELECTROPHYSIOLOGY

07:30 – 08:15	Breakfast (Perouse Randwick)
<b>SUNRISE SESSION</b>	Lecture Room (WW G12)
08:30 – 09:00	<b>Introduction to Theme</b> <b>Lee Fletcher</b>   <i>Monash University</i> (VIC)
09:00 – 10:15	<b>The Golden Rules of Electrophysiology</b> <b>John Bekkers</b>   <i>Eccles Institute of Neuroscience ANU</i> (ACT)
10:15 – 10:45	Coffee Break
<b>MORNING SESSION</b>	Lecture Room (WW G12)
10:45 – 12:00	<b>Practical Aspects of Patch Clamp Recordings</b> <b>Lee Fletcher</b>   <i>Monash University</i> (VIC)
12:00 – 13:00	Lunch (UNSW Food Court)
<b>AFTERNOON PRAC</b>	ACAN Lab (WW 312)
13:00 – 13:30	<b>Pre-Lab Debrief</b> (Lowy 305)   <b>Cherry Mao</b> (Florey VIC), <b>Alex Tang</b> (UWA WA), <b>Ben Lau</b> (UNSW NSW), <b>Tobias Bluett</b> (UQ QLD), <b>Bryony Winters</b> (USyD NSW), <b>Lee Fletcher</b> (Monash VIC)
14:00 – 18:00	<b>Lab: Meeting the rigs</b>   <i>All groups</i>
<b>EVENING WORKSHOPS</b>	ACAN Lab (WW 317)
15:00 – 18:00	<b>Neuro-Electronics Workshop</b>   <i>Group A</i> <b>Ian Forster</b>   <i>Florey Institute of Neuroscience</i> (VIC)
18:30 – 19:30	Dinner (Social area – WW 360)
<b>SUNSET SESSION</b>	Meeting Room (Lowy 305)
19:30 – 22:00	<b>Student Presentations</b>



# THEME 1 | NEURONS to NETWORKS

Tuesday 12 MAY

## BUILDING BLOCKS OF NEURONS

07:30 – 07:55	Breakfast (Perouse Randwick)
<b>SUNRISE SESSION</b>	Lecture Room (WW G06)
09:00 – 10:15	<b>The Electrical Structure of The Neuron</b> <b>Greg Stuart</b>   <i>Monash University (ANU)</i>
10:15 – 10:45	Coffee Break
<b>MORNING SESSION</b>	Lecture Room (WW G06)
10:45 – 12:00	<b>Voltage-gated Ion Channels and Excitability</b> <b>Bill Connelly</b>   <i>University of Tasmania (TAS)</i>
12:00 – 13:00	Lunch (UNSW Food Court)
<b>AFTERNOON PRAC</b>	ACAN Lab (WW 312)
13:00 – 13:30	<b>Pre-Lab Debrief</b> (Lowy 305)   <b>Cherry Mao</b> (Florey VIC), <b>Alex Tang</b> (UWA WA), <b>Ben Lau</b> (UNSW NSW), <b>Tobias Bluett</b> (UQ QLD), <b>Bryony Winters</b> (USyD NSW), <b>Lee Fletcher</b> (Monash VIC)
13:30 – 18:00	<b>Lab: Current and voltage relationships in neurons</b>   <i>All groups</i>
<b>EVENING WORKSHOPS</b>	ACAN Lab (WW 317)
15:00 – 18:00	<b>Neuro-Electronics Workshop</b>   <i>Group B</i> <b>Ian Forster</b>   <i>Florey Institute of Neuroscience (VIC)</i>
18:30 – 19:30	Dinner (Social area – WW 360)
<b>SUNSET SESSION</b>	ACAN Lab (WW 312)
19:30 – Late.	<b>Lab After-hours</b>   <i>All groups</i>



# THEME 1 | NEURONS to NETWORKS

Wednesday 13 MAY

## NEURONAL COMMUNICATION

07:30 – 08:45	Breakfast (Perouse Randwick)
<b>SUNRISE SESSION</b>	Lecture Room (WW G01)
09:00 – 10:15	<b>Axons and Signal Transmission</b> <b>Maarten Kole</b>   <i>Netherlands Institute for Neuroscience and Utrecht University</i> (Netherlands)
10:15 – 10:45	Coffee Break
<b>MORNING SESSION</b>	Lecture Room (WW G01)
10:45 – 12:00	<b>Neurotransmission and Synaptic Function</b> <b>Karl Iremonger</b>   <i>University of Otago</i> (NZ)
12:00 – 13:00	Lunch (UNSW Food Court)
<b>AFTERNOON PRAC</b>	ACAN Lab (WW 312)
13:00 – 13:30	<b>Pre-Lab Debrief</b> (Lowy 305)   <b>Cherry Mao</b> (Florey VIC), <b>Alex Tang</b> (UWA WA), <b>Ben Lau</b> (UNSW NSW), <b>Tobias Bluett</b> (UQ QLD), <b>Bryony Winters</b> (USyD NSW), <b>Lee Fletcher</b> (Monash VIC)
13:30 – 18:00	<b>Lab: Action potential dynamics</b>   <i>All groups</i>
<b>EVENING WORKSHOPS</b>	ACAN Lab (WW 312)
15:00 – 18:00	<b>In Vivo Recording Workshop</b> <b>Saba Gharaei</b>   <i>Eccles Institute of Neuroscience, ANU</i> (ACT)
18:30 – 19:30	Dinner (Social area – WW 360)
<b>SUNSET SESSION</b>	ACAN Lab (WW 312)
19:30 – Late.	<b>Lab After-hours</b>   <i>All groups</i>



# THEME 1 | NEURONS to NETWORKS

Thursday 14 MAY

## SYNAPTIC PLASTICITY

07:30 – 08:45	Breakfast (Perouse Randwick)
<b>SUNRISE SESSION</b>	Lecture Room (WW G01)
09:00 – 10:15	<b>Synaptic Dynamics, Plasticity, and Modulation</b> <b>Elena Bagley</b>   <i>University of Sydney (NSW)</i>
10:15 – 10:45	Coffee Break
<b>MORNING SESSION</b>	Lecture Room (WW G01)
10:45 – 12:00	<b>Neuronal Mechanisms of Learning and Memory</b> <b>Christine Grienberger</b>   <i>Brandeis University (Massachusetts, USA)</i>
12:00 – 13:00	Lunch (UNSW Food Court)
<b>AFTERNOON PRAC</b>	ACAN Lab (WW 312)
13:00 – 13:30	<b>Pre-Lab Debrief</b> (Lowy 305)   <b>Cherry Mao</b> (Florey VIC), <b>Alex Tang</b> (UWA WA), <b>Ben Lau</b> (UNSW NSW), <b>Tobias Bluett</b> (UQ QLD), <b>Bryony Winters</b> (USyD NSW), <b>Lee Fletcher</b> (Monash VIC)
13:30 – 18:00	<b>Lab: Excitatory and Inhibitory Synaptic Potentials</b>   <i>All groups</i>
<b>EVENING WORKSHOPS</b>	ACAN Lab (WW 312)
15:00 – 18:00	<b>In Vivo Recording Workshop</b> <b>Saba Gharaei</b>   <i>Eccles Institute of Neuroscience, ANU (ACT)</i>
18:30 – 19:30	Dinner (Social area – WW 360)
<b>SUNSET SESSION</b>	Pioneer International Theatre (WW LG03)
19:30 – 20:30	<b>Special Lecture</b> <b>TBD</b> <b>Christine Grienberger</b>   <i>Brandeis University (Massachusetts, USA)</i>
20:30 – Late.	Post Lecture Discussion / Lab



# THEME 1 | NEURONS to NETWORKS

Friday 15 MAY

## NEURONAL OPERATION

07:30 – 08:45	Breakfast (Perouse Randwick)
<b>SUNRISE SESSION</b>	Lecture Room (WW G12)
09:00 – 10:15	<b>Dendritic Integration</b> <b>Stephen Williams</b>   <i>Monash University (VIC)</i>
10:15 – 10:45	Coffee Break
<b>MORNING SESSION</b>	Lecture Room (WW G12)
10:45 – 12:00	<b>In Vivo Patch Clamp and recording techniques</b> <b>Saba Gharaei</b>   <i>Eccles Institute of Neuroscience ANU (ACT)</i>
12:00 – 13:00	Lunch (UNSW Food Court)
<b>AFTERNOON PRAC</b>	ACAN Lab (WW 312)
13:00 – 13:30	<b>Pre-Lab Debrief</b> (Lowy 305)   <b>Cherry Mao</b> (Florey VIC), <b>Alex Tang</b> (UWA WA), <b>Ben Lau</b> (UNSW NSW), <b>Tobias Bluett</b> (UQ QLD), <b>Bryony Winters</b> (USyD NSW), <b>Lee Fletcher</b> (Monash VIC)
13:30 – 18:00	<b>Lab: Neural Circuits</b>   <i>All groups</i>
<b>EVENING WORKSHOPS</b>	ACAN Lab (WW 312)
15:00 – 18:00	<b>In Vivo Recording Workshop</b>   <i>Group 2</i> <b>Saba Gharaei</b>   <i>Eccles Neuroscience Institute (ACT)</i>
18:30 – 19:30	Dinner (Social area – WW 360)
<b>SUNSET SESSION</b>	ACAN Lab (WW 312)
19:30 – Late.	<b>Lab After-hours</b>   <i>All groups</i>



# THEME 1 | NEURONS to NETWORKS

Saturday 16 MAY

## NEURONAL FUNCTION

07:30 – 08:45	Breakfast (Perouse Randwick)
<b>SUNRISE SESSION</b>	Lecture Room (G01)
09:00 – 10:15	<b>Neural Coding and Information Theory</b> <b>Ehsan Arabzadeh</b>   <i>Eccles Institute of Neuroscience ANU (ACT)</i>
10:15 – 10:45	Coffee Break
<b>MORNING SESSION</b>	Lecture Room (G01)
10:45 – 12:00	<b>Pre-Lab Debrief and Lab setup</b>   <b>Cherry Mao</b> (Florey VIC), <b>Alex Tang</b> (UWA WA), <b>Ben Lau</b> (UNSW NSW), <b>Tobias Bluett</b> (UQ QLD), <b>Bryony Winters</b> (USyD NSW), <b>Lee Fletcher</b> (Monash VIC)
12:00 – 13:00	Lunch (Social area – WW 360)
<b>AFTERNOON PRAC</b>	ACAN Lab (WW 312)
13:00 – 18:00	<b>Lab: Paired / Dendritic recordings</b>   <i>All groups</i>
<b>EVENING WORKSHOPS</b>	ACAN Lab (WW 312)
15:00 – 18:00	<b>In Vivo Recording Workshop</b>   <i>Group 3</i> <b>Saba Gharaei</b>   <i>Eccles Neuroscience Institute (ACT)</i>
18:30 – 19:30	Dinner (Social area – WW 360)
<b>SUNSET SESSION</b>	
19:30 – Late	Students' choice: The Lab or The Spot

Sunday 17 MAY

## FREE DAY ACTIVITY



## THEME 2 | CIRCUITS to NETWORKS

Monday 18 MAY

### MEASURING NEURAL FUNCTION WITH LIGHT

07:30 – 08:15	Breakfast (Perouse Randwick)
<b>SUNRISE SESSION</b>	Lecture Room (WW G01)
08:30 – 09:00	<b>Intro to Theme</b> <b>Christina Mo</b>   <i>Florey</i> (VIC) & <b>John Power</b>   <i>UNSW Sydney</i> (NSW)
09:00 – 10:15	<b>Fundamentals of Optics &amp; Microscopy</b> <b>Michael Carnell</b>   <i>UNSW Sydney</i> (NSW)
10:15 – 10:45	Coffee Break
<b>MORNING SESSION</b>	Lecture Room (WW G01)
10:45 – 12:00	<b>Neuronal Calcium Signalling</b> <b>John Power</b>   <i>UNSW Sydney</i> (NSW)
12:00 – 13:00	Lunch (UNSW Food Court)
<b>AFTERNOON PRAC</b>	ACAN Lab (WW 312) or Animal Facility
13:00 – 13:30	<b>Pre-Lab Debrief (Lowy 305)</b>   <i>All groups</i> <b>John Power</b> ( <i>UNSW NSW</i> ), <b>Dennis Cheung</b> ( <i>NIPS Japan</i> ), <b>Michel Herde</b> ( <i>Otago NZ</i> ), <b>Sophia Gilchrist</b> ( <i>USyD NSW</i> ) & <b>Si Yin Lui</b> ( <i>UNSW NSW</i> ), <b>Billy Chieng</b> ( <i>UNSW NSW</i> )
13:30 – 15:30	<b>Ca<sup>2+</sup> imaging in brain slices</b>   <i>Group A</i> <b>Headplate Surgery</b>   <i>Groups B</i>
15:30 – 18:00	<b>Headplate Surgery</b>   <i>Groups Group A</i> <b>Ca<sup>2+</sup> imaging in brain slices</b>   <i>Groups B</i>
18:30 – 19:30	Dinner (Social area – WW 360)
<b>SUNSET SESSION</b>	ACAN Lab (WW 312)   Meeting room (Lowy 305)
19:30 – Late.	<b>Using Image J, Lab After-hours: back at the rig!</b>   <i>All groups</i>



## THEME 2 | CIRCUITS to NETWORKS

Tuesday 19 MAY

### CONTROLLING NEURAL FUNCTION WITH LIGHT

07:30 – 07:55

Breakfast (Perouse Randwick)

#### SUNRISE SESSION

Lecture Room (WW G01)

09:00 – 10:15

**How to Probe Neuronal Circuits and Networks**  
**Christina Mo** | *Florey Institute of Neuroscience (VIC)*

10:15 – 10:45

Coffee Break

#### MORNING SESSION

Lecture Room (WW G01)

10:45 – 12:00

**Advances in Optogenetics**  
**John Lin** | *University of Tasmania (TAS)*

12:00 – 13:00

Lunch (UNSW Food Court)

#### AFTERNOON PRAC

ACAN Lab (WW 312) or TNF (WW 354A)

13:00 – 13:30

**Pre-Lab Debrief** (Lowy 305) | *All groups*  
**John Power** (UNSW NSW), **Dennis Cheung** (NIPS Japan),  
**Michel Herde** (Otago NZ), **Sophia Gilchrist** (USyD NSW) &  
**Si Yin Lui** (UNSW NSW), **Billy Chieng** (UNSW NSW)

13:30 – 18:00

**Optogenetics or Ca<sup>2+</sup> imaging in brain slices** | *Group A*  
**Cranial Window Surgery (TNF)** | *Group B*

18:30 – 19:30

Dinner (Social area – WW 360)

#### SUNSET SESSION

ACAN Lab (WW 312)

19:30 – Late.

**Lab After-hours** | *All groups*



## THEME 2 | CIRCUITS to NETWORKS

Wednesday 20 MAY

### A WINDOW TO NEURAL FUNCTION

07:30 – 08:45

Breakfast (Perouse Randwick)

#### SUNRISE SESSION

Lecture Room (WW G01)

09:00 – 10:15

**Molecular Mechanisms of Synaptic Function**

**Victor Anggono** | *Queensland Brain Institute (QBI)*

10:15 – 10:45

Coffee Break

#### MORNING SESSION

Lecture Room (WW G01)

10:45 – 12:00

**How to Investigate Peripheral Circuits**

**Johanna Montgomery** | *University of Auckland (NZ)*

12:00 – 13:00

Lunch (UNSW Food Court)

#### AFTERNOON PRAC

ACAN Lab (WW 312) or TNF (WW 354A)

13:00 – 13:30

**Pre-Lab Debrief** | *All groups*

**John Power** (UNSW NSW), **Michel Herde** (Otago NZ),  
**Sophia Gilchrist** (USyD NSW), **Si Yin Lui** (UNSW NSW),  
**Billy Chieng** (UNSW NSW)

13:30 – 18:00

**Optogenetics or Ca<sup>2+</sup> imaging in brain slices** | *Group B*

**Cranial Window Surgery (TNF)** | *Group A*

18:30 – 19:30

Dinner (Social area – WW 360)

#### SUNSET SESSION

Wallace Wurth Seminar Room (WW LG03)

19:30 – 20:30

**Special Lecture Diamond Voltage Imaging Microscopy**

**David Simpson** | *University of Melbourne (VIC)*

20:30 – Late.

Post Lecture Discussion



## THEME 2 | CIRCUITS to NETWORKS

Thursday 21 MAY

### FUNCTIONAL IMAGING IN WHOLE SYSTEMS

07:30 – 08:45

Breakfast (Perouse Randwick)

#### SUNRISE SESSION

Lecture Room (WW G01)

09:00 – 10:15

**Light-sheet Imaging of Whole Brain Networks in Zebra Fish**  
**Ethan Scott** | *University of Melbourne* (VIC)

10:15 – 10:45

Coffee Break

#### MORNING SESSION

Lecture Room (WW G01)

10:45 – 12:00

**Using Brain organoids to Model Disease**  
**Lezanne Ooi** | *University of Wollongong* (NSW)

12:00 – 13:00

Lunch (UNSW Food Court)

#### AFTERNOON PRAC

Imaging Labs (TNF | ACAN Lab | Katharina Gaus Facility)

13:00 – 13:30

**Pre-Lab Debrief** | *All groups*

13:30 – 18:00

*Group rotations (groups X, Y, Z)*

**2P Imaging head-fixed mouse**

**Dennis Cheung** (*NIPS Japan*) & **Christina Mo** (*Florey VIC*)

**Dendritic Imaging**

**KGLMF staff** | *UNSW Sydney* (NSW) & **Michel Herde** (*Otago NZ*)

**Multi-Electrode Arrays**

**Lezanne Ooi** (Wollongong NSW) & **Albert Steiner** *3Brain AG* (Switzerland)

18:30 – 19:30

Dinner (Social area – WW 360)

#### SUNSET SESSION

19:30 – 21:30

*Group rotations (continued)*



## THEME 2 | CIRCUITS to NETWORKS

Friday 22 MAY

### FUNCTIONAL IMAGING IN WHOLE SYSTEMS

07:30 – 08:45

Breakfast (Perouse Randwick)

#### SUNRISE SESSION

Lecture Room (WW G01)

09:00 – 10:15

**Holographic Microscopy**

**Vince Daria** | *Australian National University (ACT)*

10:15 – 10:45

Coffee Break

#### MORNING SESSION

Lecture Room (WW G01)

10:45 – 12:00

**Analysing Neural Populations**

**Clarissa Whitmire** (*QBI QLD*)

12:00 – 13:00

Lunch (UNSW Food Court)

#### AFTERNOON PRAC

ACAN Computing Lab (**TBD**)

**Analysing Population Data**

13:00 – 16:00

**2P image analysis**

**Clarissa Whitmire** (*QBI QLD*) & **Christina Mo** (*Florey VIC*)

16:30 – 18:00

**MEA analysis pipeline**

**Lezanne Ooi** (*Wollongong NSW*) & **Albert Steiner** (*3Brain AG Switzerland*)

18:30 – 19:30

Dinner (Social area – WW 360)

#### SUNSET SESSION

ACAN Computing Lab (**TBD**)

19:30 – 21:00

**MEA Analysis (continued)**

**Lezanne Ooi** (*Wollongong NSW*) & **Albert Steiner** (*3Brain AG Switzerland*)



## THEME 2 | CIRCUITS to NETWORKS

Saturday 23 MAY

WRAP UP!

07:30 – 08:45

Breakfast (Perouse Randwick)

MORNING

ACAN Computing Lab (**TBD**) | Lecture Room (G01)

09:00 – 12:00

**Data Analysis** | *All Groups*

**Clarissa Whitmire** (QBI QLD) & **Christina Mo** (Florey VIC)

**Michel Herde** (Otago NZ), **John Power** (UNSW NSW)

**Albert Steiner** 3Brain AG (Switzerland)

12:00 – 13:00

Lunch (Social area – WW 360)

AFTERNOON

Lecture Room (G01)

13:00 – 15:00

**Data Analysis** | *All Groups*

16:00 – 18:00

**Student Presentations** | *All students*

18:30 – 19:30

Dinner (Social area – WW 360)

SUNSET SESSION

Wallace Wurth Seminar Room (**WW LG03**)

19:30 – 20:30

*Special Lecture* **Manipulating Neuron-Glia Interactions Holographically**

**Hiro Wake** | *National Institute for Physiological Sciences (Japan)*

20:30 – Late.

Post Lecture Discussion

Sunday 24 MAY

FREE DAY ACTIVITY



# THEME 3 | SYSTEMS to BEHAVIOUR

Monday 25 MAY

## LEARNING & BEHAVIOUR

07:30 – 08:15	Breakfast (Perouse Randwick)
<b>SUNRISE SESSION</b>	Lecture Room (WW G12)
08:30 – 09:00	<b>Intro to Theme</b> <b>Jay Bertran-Gonzalez</b>   UNSW Sydney (NSW)
09:00 – 10:15	<b>Associative Learning and Behaviour</b> <b>Nathan Holmes</b>   UNSW Sydney (NSW)
10:15 – 10:45	Coffee Break
<b>MORNING SESSION</b>	Lecture Room (WW G12)
10:45 – 12:00	<b>Interrogating Neural Systems Function with Behaviour</b> <b>Karly Turner</b>   UNSW Sydney (NSW)
12:00 – 13:00	Lunch (UNSW Food Court)
<b>AFTERNOON PRAC</b>	Lecture Room   Computing Lab   Behaviour Lab
13:00 – 18:00	<b>Designing our Behavioural Experiment</b>   Rotations   WW LG03 <b>Jay Bertran-Gonzalez</b> (UNSW NSW) <b>Controlling a Conditioning Rig</b>   Rotations   WW LG02 <b>Karly Turner &amp; Beatrice Leung</b> (UNSW NSW) <b>Meet Your Mouse &amp; Training Day 1</b>   Rotations   WW LG11 <b>Chelsea Goulton</b> (UNSW NSW) & <b>Leigh Walker</b> (Floreys VIC)
18:30 – 19:30	Dinner (Social area – WW 360)
<b>SUNSET SESSION</b>	Wallace Wurth Seminar Room (WW LG03)
19:30 – 20:30	<b>Special Lecture Neuroscience of Associative Learning</b> <b>Mihaela Iordanova</b>   Concordia University (CAN)
20:30 – Late.	Post Lecture Discussion



# THEME 3 | SYSTEMS to BEHAVIOUR

Tuesday 26 MAY

## SETTING UP BRAIN SYSTEMS

07:30 – 07:55

Breakfast (Perouse Randwick)

### SUNRISE SESSION

Lecture Room (WW G06)

09:00 – 10:15

**Investigating Brain Structure and Function at the Macroscale**  
**Dylan Black** | *University of Queensland* (QLD)

10:15 – 10:45

Coffee Break

### MORNING SESSION

Lecture Room (WW G06)

10:45 – 12:00

**Studies of Neurogenesis and Neural Circuit Formation**  
**Annalisa Paolino** | *University of Queensland* (QLD)

12:00 – 13:00

Lunch (UNSW Food Court)

### AFTERNOON PRAC

ACAN Computing Lab | Behaviour Lab

13:00 – 18:00

**Training Day 2** | *All Groups* | **WW LG11**  
**Jay Bertran-Gonzalez** (*UNSW NSW*) & **Beatrice Leung** (*UNSW NSW*)

Prac 3\_1 | **In Utero Electroporation** | *Group 1* | **LG10**  
**Annalisa Paolino** (*UQ QLD*) & **Dylan Black** (*UQ QLD*)

Prac 3\_2 | **Advanced Behaviour** | *Group 2* | **TBD**  
**Chris Nolan** & **Tom Burton** (*UNSW, NSW*)

Prac 3\_3 | **In Vivo Fibre Photometry** | *Group 3* | **WW LG13**  
**Chelsea Goulton**, **Phil JRDB** (*UNSW NSW*), **Leigh Walker** (*Florey VIC*)

18:30 – 19:30

Dinner (Social area – WW 360)

### SUNSET SESSION

Wallace Wurth Seminar Room (WW LG03)

19:30 – 20:30

**Special Lecture Astrocyte Evolution**  
**Carmen Falcone** | *Towson University* (USA)

20:30 – Late.

Post Lecture Discussion



# THEME 3 | SYSTEMS to BEHAVIOUR

Wednesday 27 MAY

## LEARNING AND NEUROMODULATION (I)

07:30 – 08:45

Breakfast (Perouse Randwick)

### SUNRISE SESSION

Lecture Room (WW G12)

09:00 – 10:15

*Studying Neural Systems in vivo*

Lizzie Manning | *University of Newcastle* (NSW)

10:15 – 10:45

Coffee Break

### MORNING SESSION

Lecture Room (WW G12)

10:45 – 12:00

*Capturing Learning through Fibre Photometry*

Philip Jean-Richard Dit Bressel | *UNSW Sydney* (NSW)

12:00 – 13:00

Lunch (UNSW Food Court)

### AFTERNOON PRAC

ACAN Computing Lab | Behaviour Lab

13:00 – 18:00

*Training Day 3* | *All Groups* | WW LG11

Jay Bertran-Gonzalez (*UNSW NSW*) & Beatrice Leung (*UNSW NSW*)

Prac 3\_1 | *In Utero Electroporation* | *Group 2* | LG10

Annalisa Paolino (*UQ QLD*) & Dylan Black (*UQ QLD*)

Prac 3\_2 | *Advanced Behaviour* | *Group 3* | TBD

Chris Nolan & Tom Burton (*UNSW, NSW*)

Prac 3\_3 | *In Vivo Fibre Photometry* | *Group 1* | WW LG13

Chelsea Goulton, Phil JRDB (*UNSW NSW*), Leigh Walker (*Florey VIC*)

18:30 – 19:30

Dinner (Social area – WW 360)

### SUNSET SESSION

Wallace Wurth Seminar Room (WW LG03)

19:30 – 20:30

*Special Lecture* *Unique Signatures for Learning in Distinct Dopamine Circuits*

Melissa Sharpe | *University of Sydney* (NSW)

20:30 – Late.

Post Lecture Discussion



## THEME 3 | SYSTEMS to BEHAVIOUR

Thursday 28 MAY

### LEARNING AND NEUROMODULATION (II)

07:30 – 08:45	Breakfast (Perouse Randwick)
<b>SUNRISE SESSION</b>	Lecture Room (WW G06)
09:00 – 10:15	<b>Acetylcholine Systems in the Striatum</b> <b>Nathalie Dehorter</b>   <i>Queensland Brain Institute</i> (UQ)
10:15 – 10:45	Coffee Break
<b>MORNING SESSION</b>	Lecture Room (WW G06)
10:45 – 12:00	<b>Muscarinic Control of Neural Function and Chemogenetics</b> <b>Leigh Walker</b>   <i>The Florey Institute of Neuroscience</i> (VIC)
12:00 – 13:00	Lunch (UNSW Food Court)
<b>AFTERNOON PRAC</b>	ACAN Computing Lab   Behaviour Lab
13:00 – 18:00	<b>Learning Encoding Test 1</b>   <i>All Groups</i>   <b>WW LG11</b> <b>Jay Bertran-Gonzalez</b> (UNSW NSW) & <b>Beatrice Leung</b> (UNSW NSW)
	Prac 3_1   <b>In Utero Electroporation</b>   <i>Group 3</i>   <b>LG10</b> <b>Annalisa Paolino</b> (UQ QLD) & <b>Dylan Black</b> (UQ QLD)
	Prac 3_2   <b>Advanced Behaviour</b>   <i>Group 1</i>   <b>TBD</b> <b>Chris Nolan</b> & <b>Tom Burton</b> (UNSW, NSW)
	Prac 3_3   <b>In Vivo Fibre Photometry</b>   <i>Group 2</i>   <b>WW LG13</b> <b>Chelsea Goulton</b> , <b>Phil JRDB</b> (UNSW NSW), <b>Leigh Walker</b> (Florey VIC)
18:30 – 19:30	Dinner (Social area – WW 360)
<b>SUNSET SESSION</b>	Wallace Wurth Seminar Room (WW LG03)
19:30 – 20:30	<b>Special Lecture Dopamine, Acetylcholine and Corticostriatal plasticity</b> <b>John Reynolds</b>   <i>University of Otago</i> (NZ)
20:30 – Late.	Post Lecture Discussion



# THEME 3 | SYSTEMS to BEHAVIOUR

Friday 29 MAY

## SYSTEMS FAILURE

07:30 – 08:45

Breakfast (Perouse Randwick)

### SUNRISE SESSION

Lecture Room (WW G01)

09:00 – 10:15

**Subcortical Systems and Disease**

**Robyn Brown** | *The Florey Institute of Neuroscience* (VIC)

10:15 – 10:45

Coffee Break

### MORNING SESSION

Lecture Room (WW G01)

10:45 – 12:00

**Synaptic Genes & Cognition**

**Jess Nithianantharajah** | *Florey Institute of Neuroscience* (VIC)

12:00 – 13:00

Lunch (UNSW Food Court)

### AFTERNOON PRAC

Lecture Room | Behaviour Lab

13:00 – 18:00

**Learning Encoding Test 2** | *All Groups* | **WW LG11**

**Jay Bertran-Gonzalez** (UNSW NSW) & **Beatrice Leung** (UNSW NSW)

**INTEGRATIVE WORKSHOP** | WW G06

**Lee Fletcher** (Monash VIC), **Christina Mo** (Florey VIC), **John Power** (UNSW NSW) & **Jay Bertran-Gonzalez** (UNSW NSW)

*Discussion-based session aimed at integrating the fundamental concepts acquired during the course with a novel experimental research program individually or as groups. Students will work on their research question together with faculty.*

18:30 – 19:30

Dinner (Social area – WW 360)

### SUNSET SESSION

Wallace Wurth Seminar Room (WW LG03)

19:30 – Late.

**Preparation of Presentations** | *All Groups*



# THEME 3 | SYSTEMS to BEHAVIOUR

## Saturday 30 MAY

## WRAP UP!

07:30 – 08:45

Breakfast (Perouse Randwick)

### MORNING PRAC

Lecture Room (G01) & Computing Lab (TBD)

09:00 – 12:00

Preparation of Presentations | *All Groups*

Behavioural data processing | *Selected groups*

12:00 – 13:00

Lunch (Social area – WW 360)

### AFTERNOON SESSION

Lecture Room (WW G01)

13:00 – 19:30

Student Presentations | *All students*

Conditioning Experiment Results | *All students*

### SUNSET SESSION

Coogee Beach

19:30 – 21:00

END OF COURSE DINNER

21:00 – Late.

Drinks Coogee + The Spot

## Sunday 31 MAY

## RETURN HOME

07:30 – 09:00

Breakfast (Perouse Randwick)

09:00 –

Checkout and Safe return home.



## COURSE FACULTY

### BOARD OF DIRECTORS

Jay Bertran-Gonzalez (UNSW)

Christina Mo (Florey)

Lee Fletcher (Monash)

John Power (UNSW)

Robyn Brown (UniMelb)

Michael Carnell (UNSW)

John Lin (UTAS)

Johanna Montgomery (Auckland)

Christina Mo (Florey)

David Simpson (UniMelb)

Hiro Wake (NIPS, Japan)

Lezanne Ooi (UoW)

Ethan Scott (UniMelb)

Vince Daria (ANU)

Nathan Holmes (UNSW)

Karly Turner (UNSW)

Melissa Sharpe (USyD)

Dylan Black (UQ)

Annalisa Paolino (UQ)

Carmen Falcone (Towson, USA)

Lizzie Manning (UoN)

Phil JRDB (UNSW)

Mihaela Iordanova (Concordia, CAN)

Nathalie Dehorter (QBI)

Leigh Walker (Florey)

John Reynolds (Otago)

Robyn Brown (UniMelb)

Jess Nithianantharajah (Florey)

### COORDINATORS

Alex Tang (UWA)

Chelsea Goulton (UNSW)

Beatrice Leung (UNSW)

Benjamin Lau (UNSW)

Dennis Cheung (NIPS, Japan)

### LECTURERS

John Bekkers (ANU)

Greg Stuart (Monash)

Lee Fletcher (Monash)

Bill Connelly (UTAS)

Maarten Kole (Utrecht, Netherlands)

Karl Iremonger (Otago)

Elena Bagley (USyD)

Christine Grienberger (Brandeis, USA)

Stephen Williams (Monash)

Saba Gharaei (ANU)

Ehsan Arabzadeh (ANU)

Clarissa Whitmire (QBI)

John Power (UNSW)



## COURSE FACULTY

### LABORATORY INSTRUCTORS

Ian Forster (Florey)

Lee Fletcher (Monash)

Cherry Mao (Florey)

Alex Tang (UWA)

Benjamin Lau (UNSW)

Tobias Bluett (UQ)

Bryony Winters (USyD)

Yossi Buskila (UWS)

Saba Gharaei (ANU)

John Power (UNSW)

Michel Herde (Otago)

Dennis Cheung (NIPS, Japan)

Sophia Gilchrist (USyD)

Si Yin Lui (UNSW)

Billy Chieng (UNSW)

Christina Mo (Florey)

Albert Steiner (3Brain, Switzerland)

Jay Bertran-Gonzalez (UNSW)

Beatrice Leung (UNSW)

Chelsea Goulton (UNSW)

Christopher Nolan (UNSW)

Thomas Burton (UNSW)

Dylan Black (UQ)

Annalisa Paolino (UQ)

Karly Turner (UNSW)

Phil Jean-Richard Dit Bressel (UNSW)

Leigh Walker (Florey)



STUDENTS

TBA



STUDENT BIOSKETCHES

TBA



The Australasian Neuroscience Society and Finkel Foundation's ACAN is proudly supported by:

INSTITUTIONAL PARTNERS

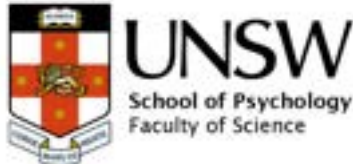

## SPONSORS

